

Selfie



- Designed to enable easy bending into a curve.
- Ready to be bent into L-shaped, S-shaped, U-shaped and other shaped curves.
- Special bender enables bending by hand at the installation site.

Selfie

Selfie's Unique Features and Applications

Curving flexibility.

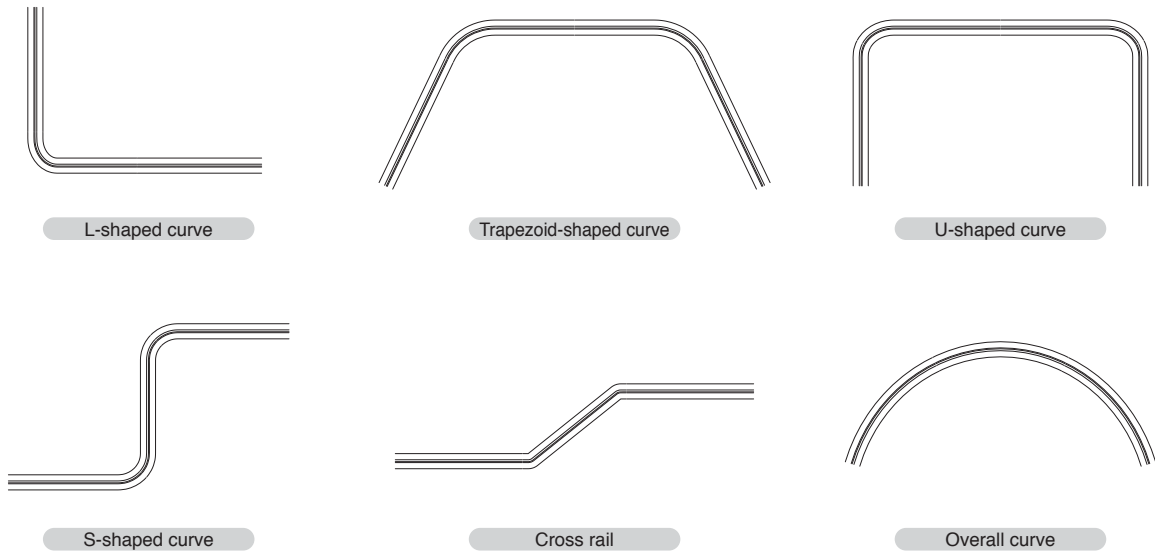

Smooth and quiet rollers.

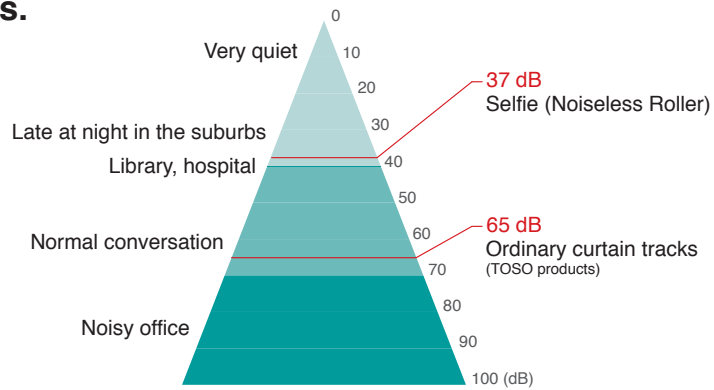

Exceptionally easy installation.

- The rail is vertically symmetrical and not direction-sensitive, resulting in easier, more efficient installation.
- The horizontally symmetrical I-shaped design makes the bend easy to undo.

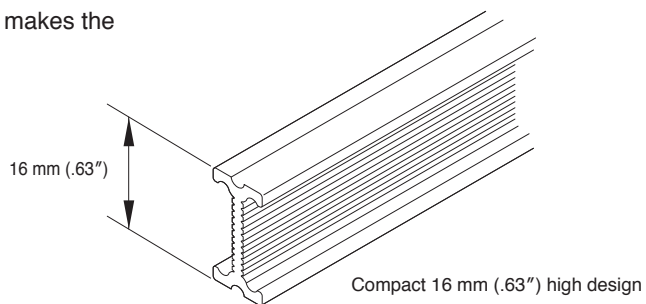

An easy way to stylish window treatment using the New Valance Rail.

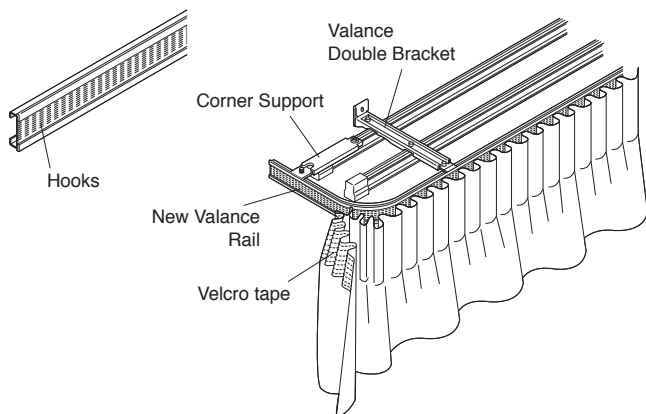

Velcro tape/pencil pleats



Velcro tape/smock pleats



When using as the New Valance Rail

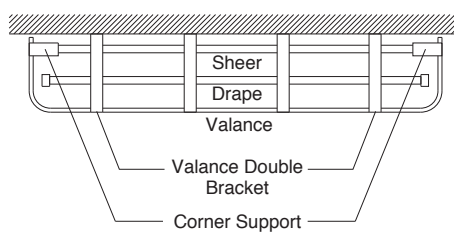

Using the bender enables easy curving.

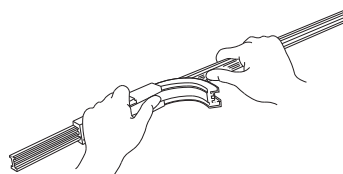

Use a joint pin at rail splices.

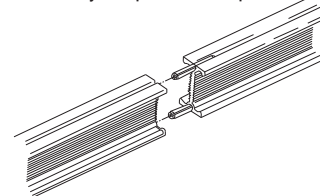

Use Intermediate Stop or Last-in Intermediate Stop for styled curtains.

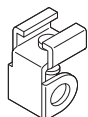

Intermediate Stop

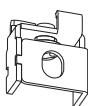

Last-in Intermediate Stop

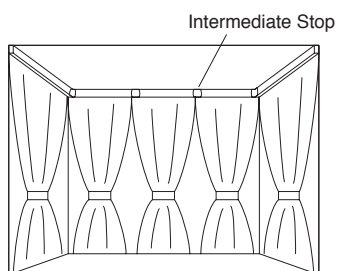

Selfie Last-in Intermediate Stop Installation Method

- Remain the screw loosened, fit the Last-in Intermediate Stop from underside of curtain rail as shown (①), turn it along with the rail and tighten the screw (②).

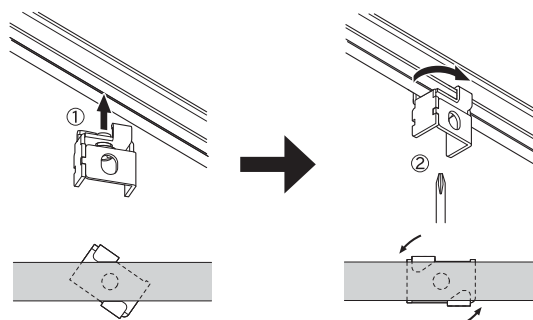

*View from above

Basic Installation Curving Method

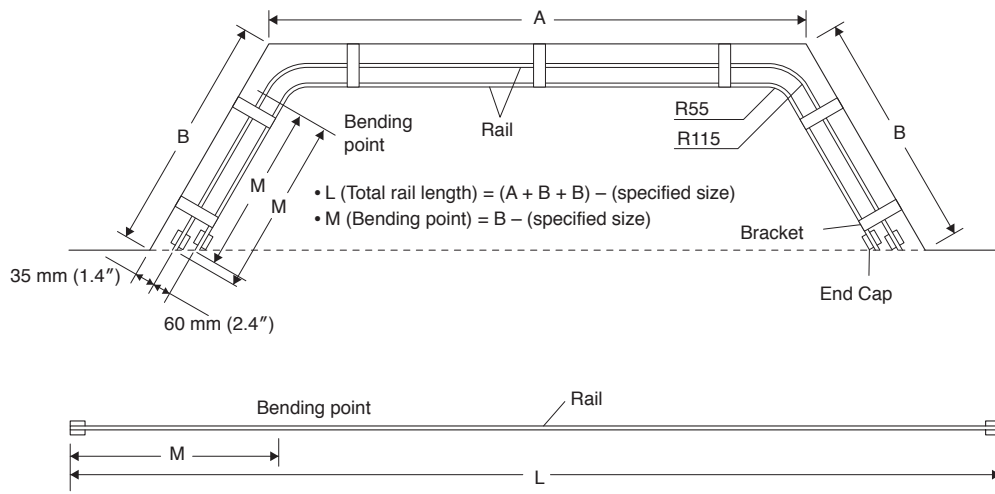

1. At the rail bending point, align the 0° point of the bender with the end of the clamp and secure.

2. Hold the bender and the rail and gradually bend the rail to the graduation mark of the desired angle.

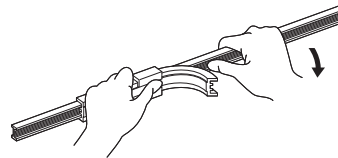
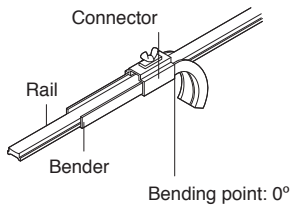

Window type	Attachment type		L (Total rail length)	M (Bending point)
90° bay window 	Single attachment	R115 use	(A + B + B) - 239 mm (9.4")	B - 150 mm (5.9")
		R55 use	(A + B + B) - 187 mm (7.4")	B - 90 mm (3.5")
	Double attachment	Exterior side (R115 use)	(A + B + B) - 239 mm (9.4")	B - 150 mm (5.9")
		Interior side (R55 use)	(A + B + B) - 427 mm (16.8")	B - 150 mm (5.9")
60° bay window 	Single attachment	R115 use	(A + B + B) - 146 mm (5.7")	B - 107 mm (4.2")
		R55 use	(A + B + B) - 133 mm (5.2")	B - 72 mm (2.8")
	Double attachment	Exterior side (R115 use)	(A + B + B) - 146 mm (5.7")	B - 107 mm (4.2")
		Interior side (R55 use)	(A + B + B) - 341 mm (13.4")	B - 142 mm (5.6")
45° bay window 	Single attachment	R115 use	(A + B + B) - 138 mm (5.4")	B - 97 mm (3.8")
		R55 use	(A + B + B) - 133 mm (5.2")	B - 72 mm (2.8")
	Double attachment	Exterior side (R115 use)	(A + B + B) - 138 mm (5.4")	B - 97 mm (3.8")
		Interior side (R55 use)	(A + B + B) - 352 mm (13.9")	B - 157 mm (6.2")

Using a Partial Bender

This is useful for making partial curves for curtain returns at both ends of a bay window curved rail to prevent light filtering into the room.

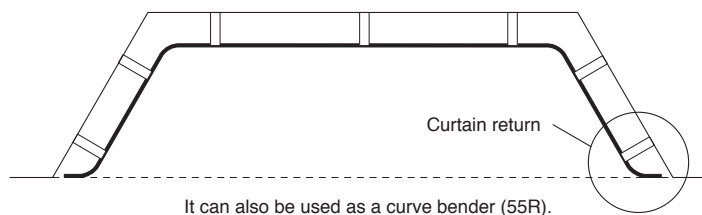

1. Insert the end of the rail into the bender. 2. Slowly bend the rail on your.

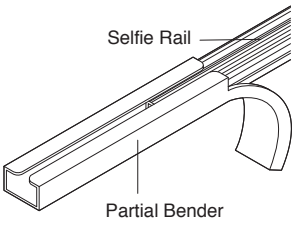

Selfie Rail

Partial Bender



Note: Do not use this bender with rails other than those specified.

Materials and Finishes

Parts	Material	Finish
Rail	Aluminum alloy extrusion material	Alumite, Alumite umber, Alumite white, Alumite warm white
Roller	Plate	Hard polyethylene
	Wheel	Acetal resin
	Oval ring	Stainless steel

Parts	Material	Finish
End Cap	Plate	Hard polyethylene
	Stop plate	Steel
	Oval ring	Stainless steel
Bracket	Body	Steel
	Snap board	Steel

Bracket Installation Interval and Allowable Curtain Load

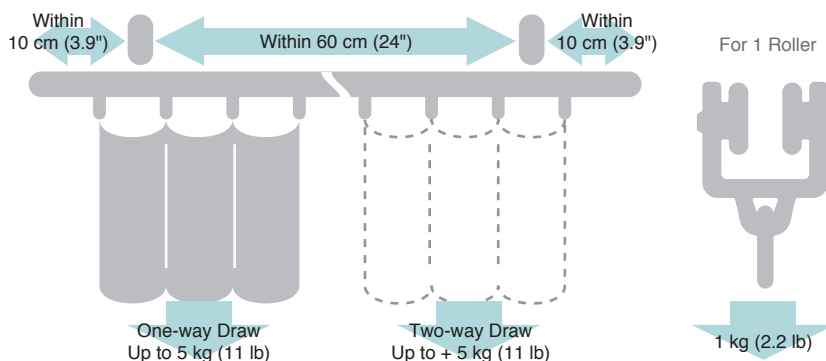

Installation Dimensions

Ceiling Attachment

Easy Snap Ceiling Single Bracket
Bracket width = 18 mm (.71")

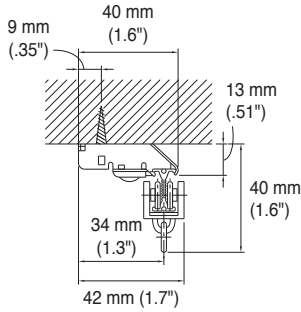

Ceiling Single Bracket
Bracket width = 14 mm (.55")

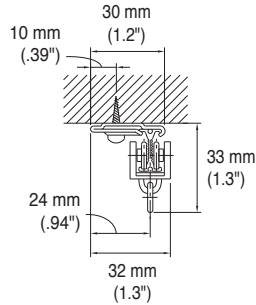

Easy Snap Ceiling Double Bracket
Bracket width = 19 mm (.75")

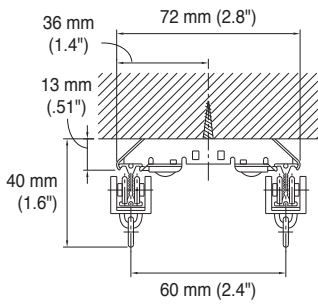

Ceiling Double Bracket
Bracket width = 18 mm (.71")

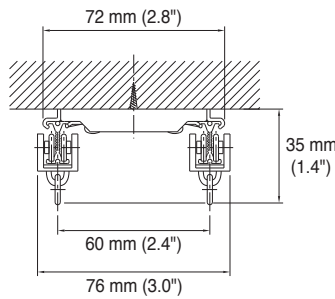

Last-in Intermediate Stop

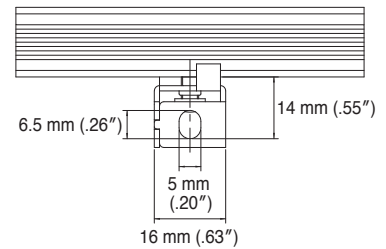

Wall Attachment

Single Bracket
Bracket width = 18 mm (.71")

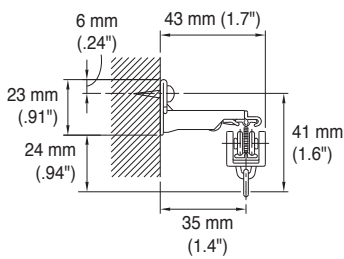

Double Bracket
Bracket width = 18 mm (.71")

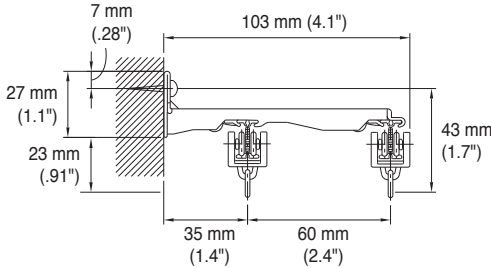

Extra Double Bracket
Bracket width = 24 mm (.94")

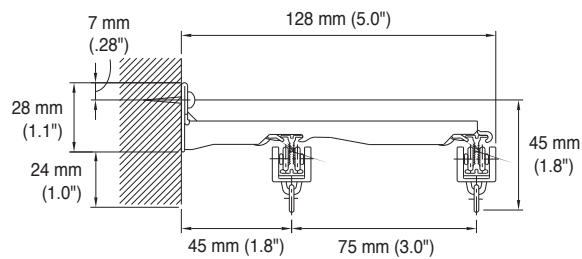

Valance Double Bracket
Bracket width = 18 mm (.71")

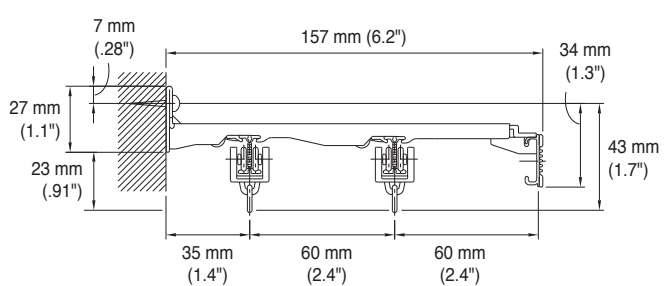

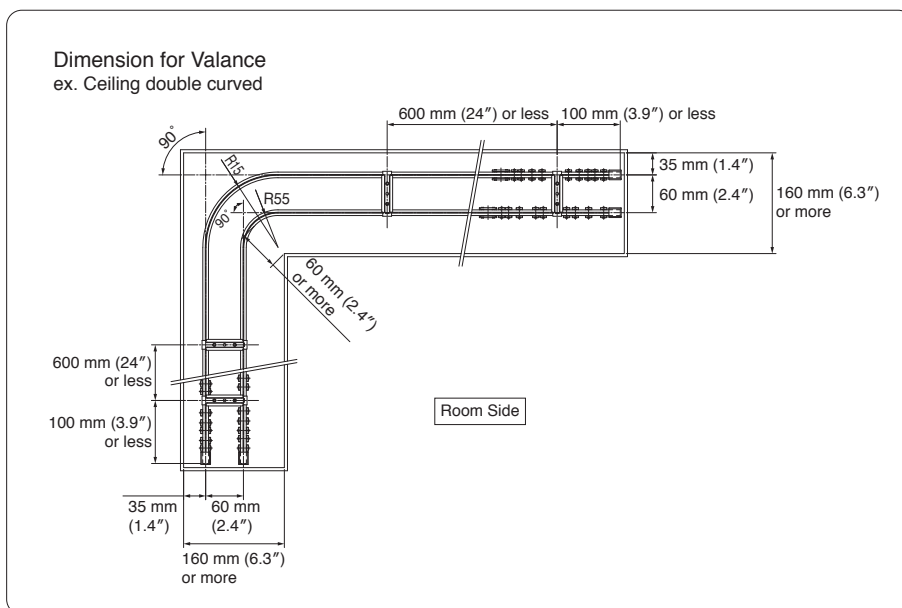

Selfie Rails



Size	Product Code			
	Silver	Umber	White	Warm white
1.82 m (72")	02330097	02330036	02330200	02330030
2.00 m (79")	02330098	02330037	02330201	02330031
2.73 m (107")	02330099	02330038	02330202	02330032
3.00 m (118")	02330100	02330039	02330203	02330033
3.64 m (143")	02330101	02330040	02330204	02330034
4.00 m (157")	02330102	02330041	02330205	02330035

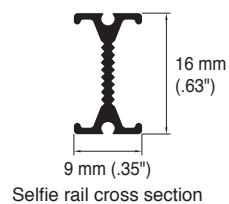

New Valance Rails





Size	Product Code
	Warm white
2.37 m (93")	02330051
3.37 m (133")	02330052

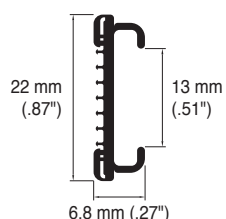





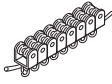
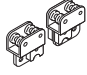
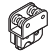
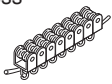
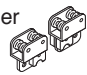
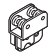

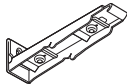
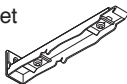
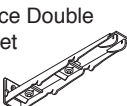
10 rails per box (not including separately manufactured rails)



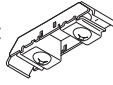
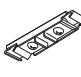
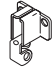

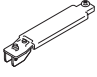

New Valance rail cross section with a Velcro (hooks)

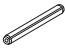
Selfie Parts

Product Name		Product Code	
Rollers	Roller (8 pieces per strip) 	Natural	02330107
		Umber	02330019
		Warm white	02330020
	MG Carrier 	Natural	02330108
		Umber	02330021
		Warm white	02330022
	One-way MG Carrier 	Natural	02330109
		Umber	02330023
		Warm white	02330024
Noiseless Roller 	Natural	30009780	
Noiseless MG Carrier 	Natural	30009781	
Noiseless One-Way MG Carrier 	Natural	30009782	
Brackets	Single Bracket 	Silver	02330111
		Umber	02330001
		Warm white	02330002
	Double Bracket 	Silver	02330112
		Umber	02330003
		Warm white	02330004
	Extra Double Bracket 	Silver	02330113
		Umber	02330076
		Warm white	02330077
	Valance Double Bracket 	Warm White	02330006

Product Name		Product Code	
Brackets	Easy Snap Ceiling Single Bracket 	Silver	02330116
		Umber	02330055
		Warm white	02330054
	Ceiling Single Bracket 	Silver	02330114
		Umber	02330007
		Warm white	02330008
	Easy Snap Ceiling Double Bracket 	Silver	02330117
		Umber	02330057
		Warm white	02330056
Ceiling Double Bracket 	Silver	02330115	
	Umber	02330009	
	Warm white	02330010	
Wall Bracket 	Silver	02330118	
	Umber	02330011	
	Warm white	02330012	
Overhead Hanger 	Silver	02330119	
	Umber	02330025	
	Warm white	02330026	
Corner Support 	Warm White	02330014	
End Cap	End Cap 	Natural	02330110
		Umber	02330015
		Warm white	02330016
Other Parts	Last-in Intermediate Stop 		30010766
	Intermediate Stop 	Natural	02330018
	Joint Pin 		02330027

Product Name		Product Code		
Adjustable Hanger Rod B		B400 (250-400 mm/ 9.8-16")	Umber	00290013
			White	00290026
		B700 (400-700 mm/ 16-28")	Umber	00290012
			White	00290025
Adjustable Hanger Rod A		A170 (130-170 mm/ 5.1-6.7")	Silver	00290034
			White	00290038
			Warm white	00290035
		A250 (170-250 mm/ 6.7-9.8")	Silver	00290036
			White	00290039
			Warm white	00290037
		A400 (245-400 mm/ 9.6-16")	Silver	00290017
			White	00290040
			Warm white	00290030
		A700 (395-700 mm/ 16-28")	Silver	00290016
			White	00290041
			Warm white	00290031
A1100 (595-1,100 mm/ 23-43")	Silver	00290015		
	White	00290042		
	Warm white	00290032		
A1600 (845-1,600 mm/ 33-63")	Silver	00290014		
	White	00290043		
	Warm white	00290033		
Curve Bender 55R			02330028	
Curve Bender 115R			02330029	
Partial Bender			00950027	