

Data Sheet

WÖHR COMBILIFT 543



Platform load options:

- max. 2000 kg, load per wheel 500 kg
- max. 2600 kg, load per wheel 650 kg **1**
- max. 3000 kg, load per wheel 750 kg **1**

Platform load can be increased later (also individual parking places)

Platforms are in horizontal position to drive on

Grid arrangement:

- minimum 2 grids for 5 vehicles
- maximum 20 grids

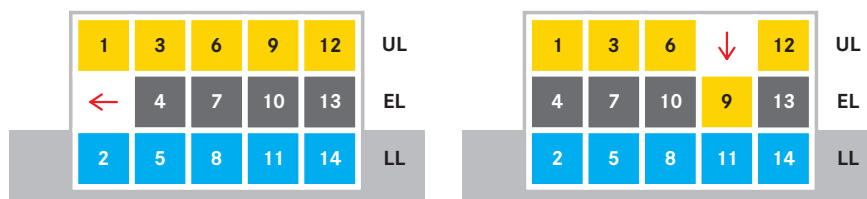

The vehicle on parking place 9 is requested. The parking places 4, 7 and 10 are shifted to the left.

Parking place 9 is lowered down to the entrance level (EL), the vehicle is now ready for exit.

Length dimensions underground car park (height dimensions see page 2)

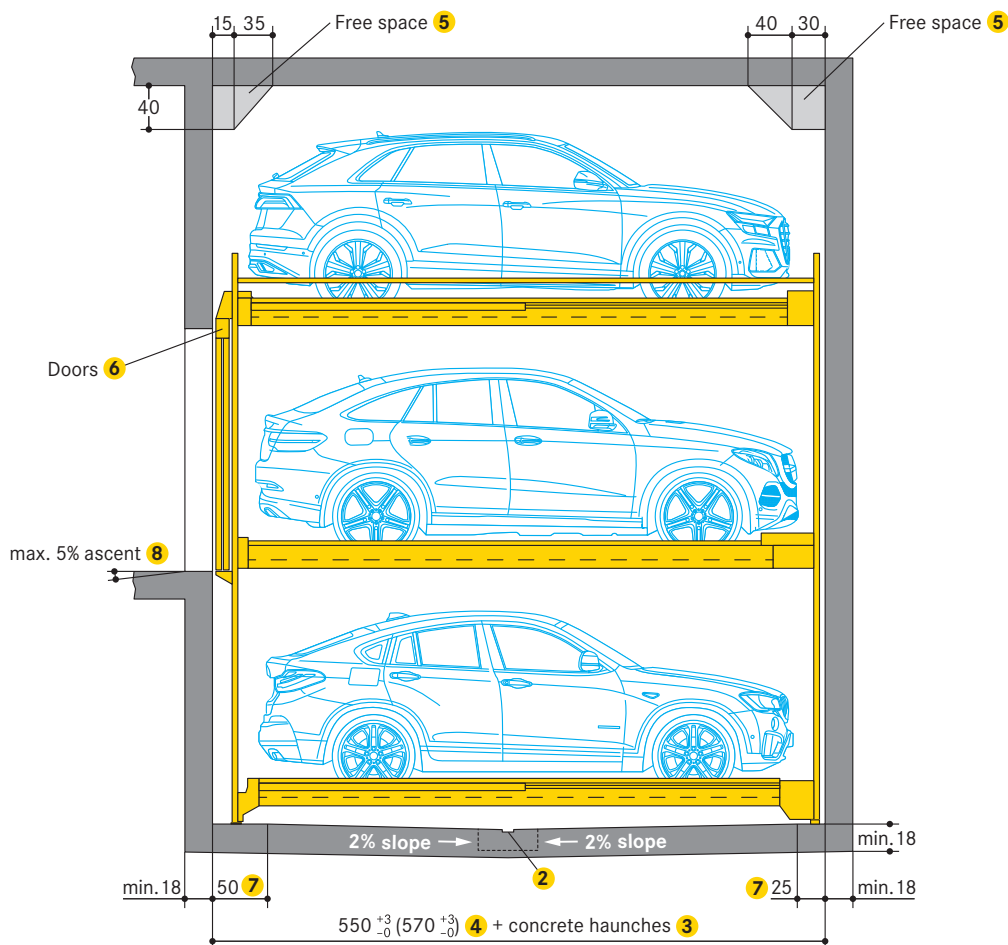

- 1** Increasing of platform load at extra cost
- 2** Drainage channels (performed by the customer):
 - 10 x 2 cm, with a 50 x 50 x 20 cm drainage pit
 - in case of installation of a sump pump, it is necessary to comply with the drainage pit dimensions specified by the pump manufacturer
- 3** Channels or undercuts/concrete haunches (performed by the customer):
 - not allowed along the pit floor-to-wall joints
 - should channels or undercuts be necessary, the system width needs to be reduced or the pit needs to be wider
- 4** 500 cm vehicle length = 550 cm pit length (including doors)
520 cm vehicle length = 570 cm pit length (including doors)
- 5** Free spaces:
 - please ask WÖHR for the dimension sheets

- 6** Doors (see page 5/6)
- 7** In this area, 0% of downward/upward slope in longitudinal and cross direction
- 8** For above ground garages, a drainage channel in the driveway is recommended

Dimensions

- all dimensions specified are the minimum, finished dimensions
- tolerances must be taken into consideration
- all dimensions are given in cm

Height dimensions

Note: The vehicle height on the lower level must be equal or lower than the vehicle height on the entrance level!
 See next page for examples of configuration

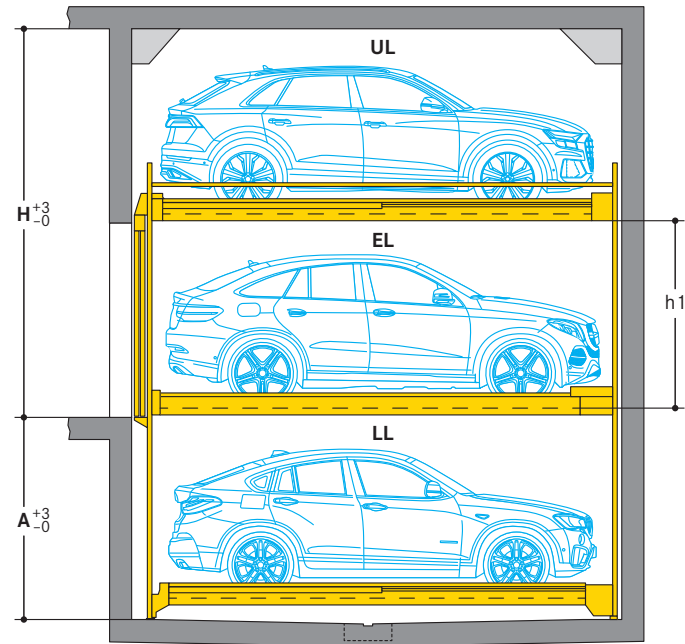

Type	Pit depth A	Vehicle height LL (lower level)
543-175	175	150
543-180	180	155
543-185	185	160
543-190	190	165
543-195	195	170
543-200	200	175
543-205	205	180
543-210	210	185
543-215	215	190
543-220	220	195
543-225	225	200
543-230	230	205
543-235	235	210
543-240	240	215
543-245	245	220

Height h1	Vehicle height EL (entrance level)	Vehicle height UL (upper level)														
		150	155	160	165	170	175	180	185	190	195	200	205	210	215	220
		Height H														
180	175	350	355	360	365	370	375	380	385	390	395	400	405	410	415	420
185	180	355	360	365	370	375	380	385	390	395	400	405	410	415	420	425
190	185	360	365	370	375	380	385	390	395	400	405	410	415	420	425	430
195	190	365	370	375	380	385	390	395	400	405	410	415	420	425	430	435
200	195	370	375	380	385	390	395	400	405	410	415	420	425	430	435	440
205	200	375	380	385	390	395	400	405	410	415	420	425	430	435	440	445
210	205	380	385	390	395	400	405	410	415	420	425	430	435	440	445	450
215	210	385	390	395	400	405	410	415	420	425	430	435	440	445	450	455
220	215	390	395	400	405	410	415	420	425	430	435	440	445	450	455	460
225	220	395	400	405	410	415	420	425	430	435	440	445	450	455	460	465

Lower heights are possible but not recommended (please contact WÖHR).

Decision support for the vehicle height

Choosing the right vehicle height for your project is essentially based on any building regulations, user expectations and building specifications. Criteria can include:

Residential buildings:

Different parking space heights are conceivable and can affect the sales price. For example, lower parking spaces could be provided for higher vehicles. This results in more convenient access to the vehicle. Less high vehicles in the upper parking spaces and thus reduced building height and less enclosed space. The ramp to the underground car park will be less steep or less long. To make it easier to sell parking spaces, we recommend that the vehicle heights be the same.

Office buildings:

For this parking concept, we recommend the same vehicle height for all parking spaces. If permanently assigned parking spaces are preferred for parking permittees, different parking space heights could be provided.

Hotels:

Whether city hotel, vacation hotel or vacation apartments: With changing occupancy, all parking spaces should have the same vehicle height. Maximum parking space heights should be selected to allow parking for vehicles with roof-mounted structures, if necessary.

Configuration example residential buildings

1	Vehicle height UL	165 cm
2	Vehicle height EL	185 cm
3	Vehicle height LL	160 cm

4	Type	543-185
5	Pit depth A	185 cm
6	Height H	375 cm

Type	Pit depth A	Vehicle height LL (lower level)
543-180	180	155
543-185	185	160

Height h1	Vehicle height EL (entrance level)	Vehicle height UL (upper level)															
		150	155	160	165	170	175	180	185	190	195	200	205	210	215	220	
		Height H															
185	180	355	360	365	370	375	380	385	390	395	400	405	410	415	420	425	
190	185	360	365	370	375	380	385	390	395	400	405	410	415	420	425	430	
195	190	365	370	375	380	385	390	395	400	405	410	415	420	425	430	435	

Configuration example office building and hotels

1	Vehicle height UL	205 cm
2	Vehicle height EL	205 cm
3	Vehicle height LL	205 cm

4	Type	543-230
5	Pit depth A	230 cm
6	Height H	435 cm

Type	Pit depth A	Vehicle height LL (lower level)
543-225	225	200
543-230	230	205

Height h1	Vehicle height EL (entrance level)	Vehicle height UL (upper level)															
		150	155	160	165	170	175	180	185	190	195	200	205	210	215	220	
		Height H															
205	200	375	380	385	390	395	400	405	410	415	420	425	430	435	440	445	
210	205	380	385	390	395	400	405	410	415	420	425	430	435	440	445	450	
215	210	385	390	395	400	405	410	415	420	425	430	435	440	445	450	455	

Impossible configuration example

Vehicle height UL	165 cm	Type	-
Vehicle height EL	185 cm	Pit depth A	-
Vehicle height LL	200 cm	Height H	-

The configuration is not possible because the vehicle height on the lower level is greater than the vehicle height on the entrance level.

The vehicle height on the lower level must be equal or lower than the vehicle height on the entrance level!

Vehicle heights

The following table is intended as a guide to help you select the platform distance and construction dimensions:

Aston-Martin DBX	168 cm
AUDI A6	151 cm
AUDI Q4	163 cm
AUDI Q7	174 cm
Bentley Bentayga	173 cm
BMW iX	170 cm
BMW X3	166 cm
BMW X5	176 cm
BMW X6	176 cm

Dacia Duster	170 cm
Ford Galaxy	175 cm
Ford Kuga	167 cm
Jaguar F-Pace	166 cm
Landrover Defender	198 cm
Maserati Levante	169 cm
Mercedes G-Class	195 cm
Mercedes GLE Coupé	173 cm
Mercedes V-Class	191 cm

Porsche Cayenne Coupé	168 cm
Porsche Macan	162 cm
Skoda Kodiak	168 cm
Tesla Model X	168 cm
Toyota Highlander	173 cm
VW Sharan	174 cm
VWT 3	196 cm
VW Tiguan	167 cm
VW Touareg	170 cm

All vehicle heights are non-binding, due to the wide range of model variants and the year of construction.

Clearance profile (for standard vehicles)

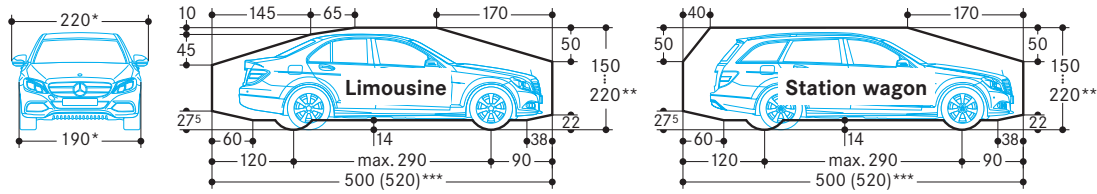

* for a 250 cm platform width
 ** The overall vehicle height including roof luggage rails an antenna mounts must not exceed the max. vehicle height dimensions specified
 *** see page 1

Width dimensions

Platform widths:

- 250 cm:
 - for 190 cm vehicle width (without outside mirror)
- 260-300 cm:
 - for vehicles wider than 190 cm (without outside mirror)
- 270-300 cm:
 - for units at the end of the driving aisle

For comfortable parking, entry and exit conditions platform widths of 250 cm are recommended. Reduced platform width means reduced parking comfort depending on the vehicle width, vehicle type, individual driving style, access situation of the garage.
 With a 90° arrangement of the parking places, we recommend widening the driving aisle or a wall recess (see below).

Width dimensions (underground car park)

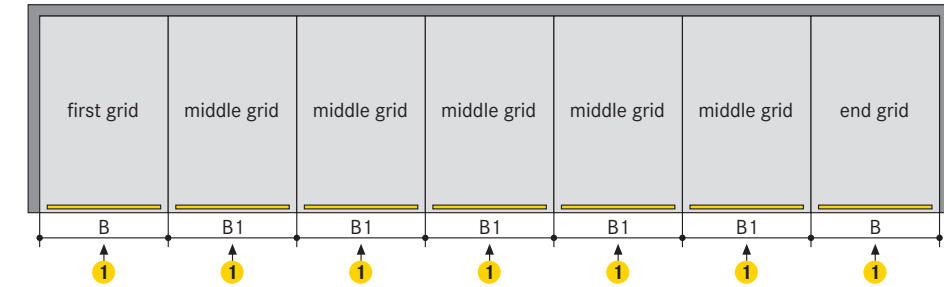

Space requirements		clear platform width
B	B1	
280	270	250
290	280	260
300	290	270
310	300	280 ③
320	310	290 ③
330	320	300 ③

- ① One entry/exit is required on entrance level (EL) for each grid
- ② For a comfortable parking process and comfortable conditions for getting in and out of the car, we recommend platform widths of at least 250 cm. Smaller platform widths are possible but not recommended (please contact WÖHR).
- ③ Platform load max. 2600 kg
- ④ It is not possible to combine different platform widths

Wall recess

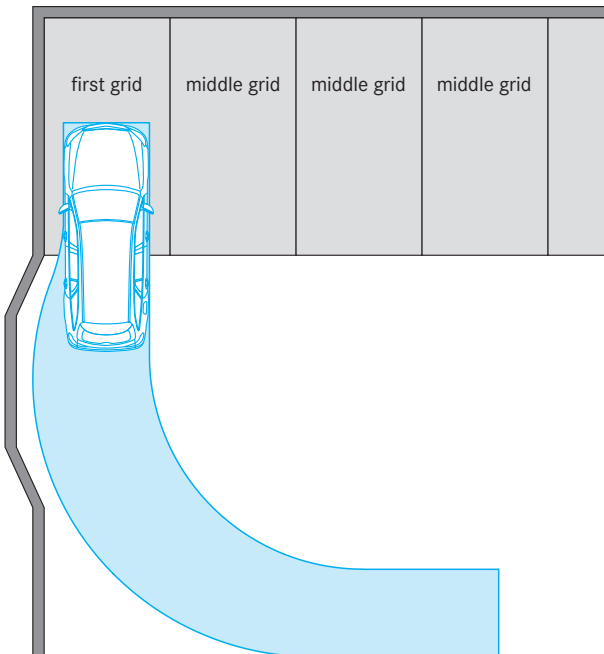

According to GaVo for Baden-Württemberg (07.07.1997/26.01.2011):
 For parking places with a 90° arrangement at the end of the driving aisle, the entrance width must be min. 275 cm.
 At the end of the driving aisle, we recommend to provide a wall recess, if technically possible.

Doors

According to DIN EN 14010 doors are required.

Automatic sliding doors:

- electrical drive
- controls are integrated in the overall system
- electro-mechanically interlocked
- can only be opened when the selected parking place has reached the entry/exit position
- any crash openings are closed in the entrance area

Local requirements for electrical doors regarding the technology, maintenance and revision are not subject of our delivery. These matters have to be observed and carried out by the customer, according to the local regulations.

Sliding doors behind the building pillars with door offset

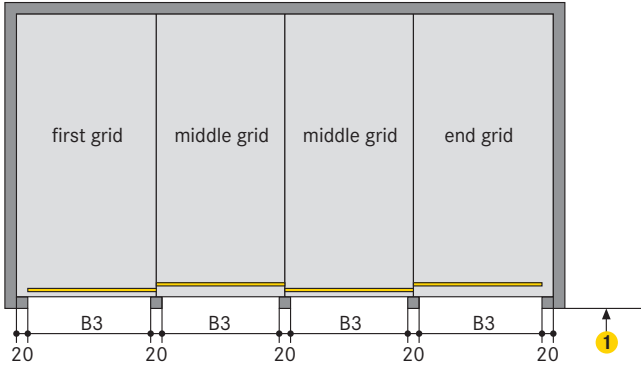

Space requirements B3	clear platform width
250	250
260	260
270	270
280	280 ②
290	290 ②
300	300 ②

- ① The driving aisle width must comply with local regulations
- ② Platform load max. 2600 kg

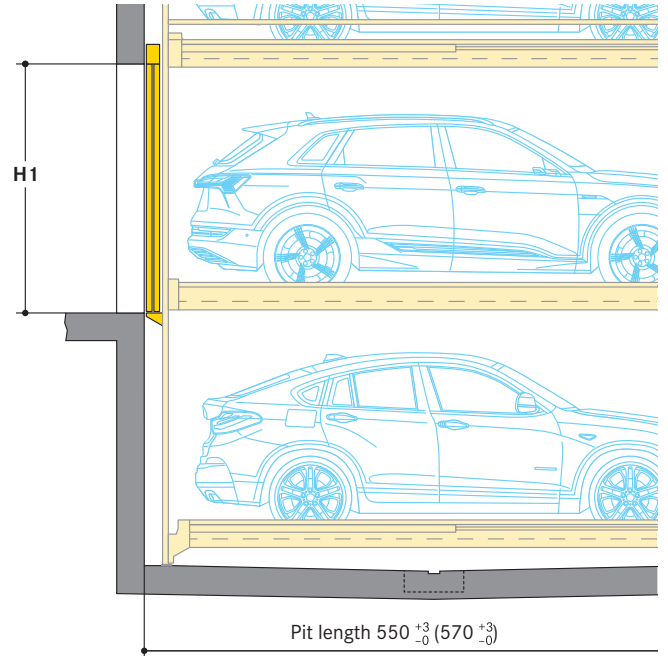

H1	Vehicle height UL (upper level) EL (entrance level)									
	175	180	185	190	195	200	205	210	215	220
	220	220	220	220	220	220	225	230	235	240

Sliding doors below the lintel between the building pillars

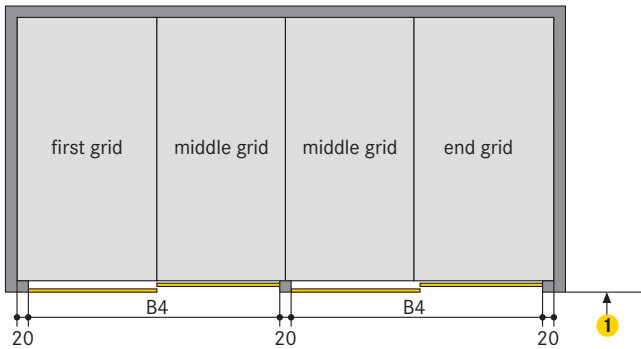

Space requirements B4	clear platform width
520	250
540	260
560	270
580	280 ②
600	290 ②
620	300 ②

- ① The driving aisle width must comply with local regulations
- ② Platform load max. 2600 kg

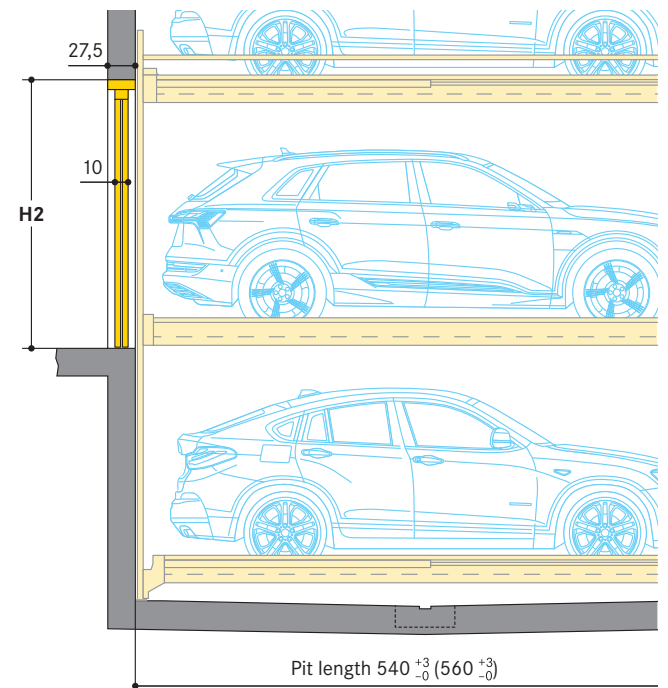

H2	Vehicle height UL (upper level) EL (entrance level)									
	175	180	185	190	195	200	205	210	215	220
	220	220	220	220	220	220	225	230	235	240

■ Sliding door floor guides

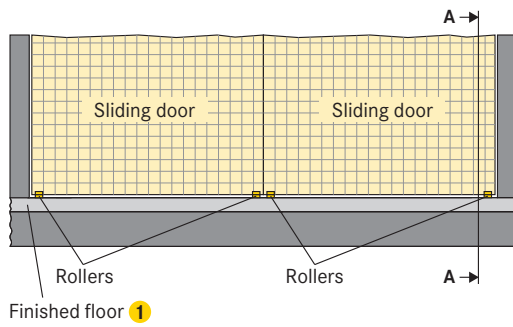

- ① Finished floor:
 - compliant to DIN 18353,
 - floor evenness compliant to DIN 18202, table 3, line 3
- ② Floor guide section:
 - base plate with plastic rollers
 - fixed on the floor with adhesive anchor (M8 internal screw thread)
 - borehole depth approx. 9 cm
 - in the event that floor filling needs to be laid into the door section to the purpose of reaching the required floor evenness, the borehole depth needs to be increased by the thickness of the floor fill (max. 4 cm)
- ③ If the driving aisle is made of concrete blocks, asphalt etc., the concrete slab of the pit edge in the door area must be min. 27,5 cm wide

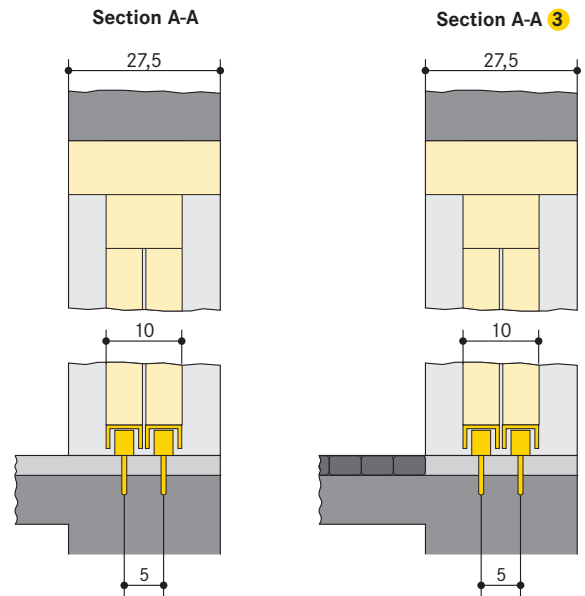

Static calculations and construction works requirement

Section

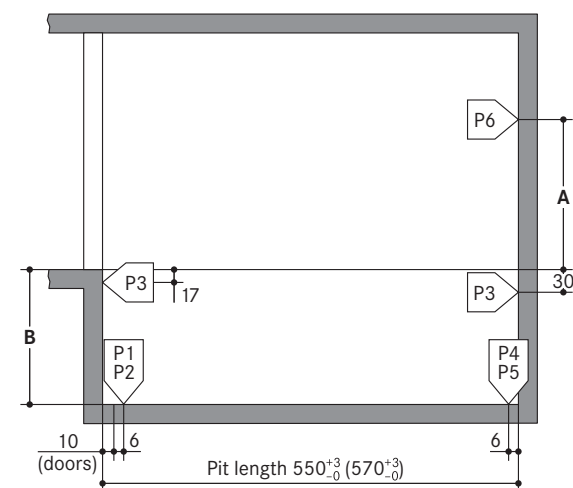

543 (2000 kg)	
P1	+ 53,0 kN*
P2	+ 26,5 kN
P3	± 1,8 kN
P4	± 28,0 kN
P5	± 14,0 kN
P6	± 1,8 kN

543 (2600 kg)	
P1	+ 68,0 kN*
P2	+ 34,0 kN
P3	± 2,5 kN
P4	± 34,0 kN
P5	± 17,0 kN
P6	± 2,5 kN

543 (3000 kg)	
P1	+ 78,0 kN*
P2	+ 39,0 kN
P3	± 3,0 kN
P4	± 38,0 kN
P5	± 19,0 kN
P6	± 3,0 kN

*specified load bearing data includes the vehicle weight

Type	A	B
543-175	207	175
543-180	212	180
543-185	217	185
543-190	222	190
543-195	227	195
543-200	232	200
543-205	237	205
543-210	242	210
543-215	247	215
543-220	252	220
543-225	257	225
543-230	262	230
543-235	267	235
543-240	272	240
543-245	277	245

Fixing of the system frames to the floor slab:

- using base plates (approx. 350 cm²)
- using adhesive anchor bolts
- hole depth to 12-14 cm
- bottom plate in concrete
- thickness of bottom plate min. 18 cm

Fixing of the system frames to the walls:

- with walls plates (approx. 30 cm²)
- using adhesive anchor bolts
- hole depth to 12-14 cm
- front drive-in wall and rear wall in concrete
- perfectly flat wall surfaces
- without protruding sections such as border edgings, pipes and tubes, etc.
- thickness of walls min. 18 cm

Concrete quality grade:

- compliant to the static requirements of the construction
- min. C20/25 grade (for dowel fastening)

Frame bearing points:

- the specified lengths are expressed as mean value
- for the exact data, specific TÜV-tested data sheets are available

Door widths/widths of columns:

- please contact WÖHR
- grid width (270/280/290/300/310/320) must be observed

Ground plan

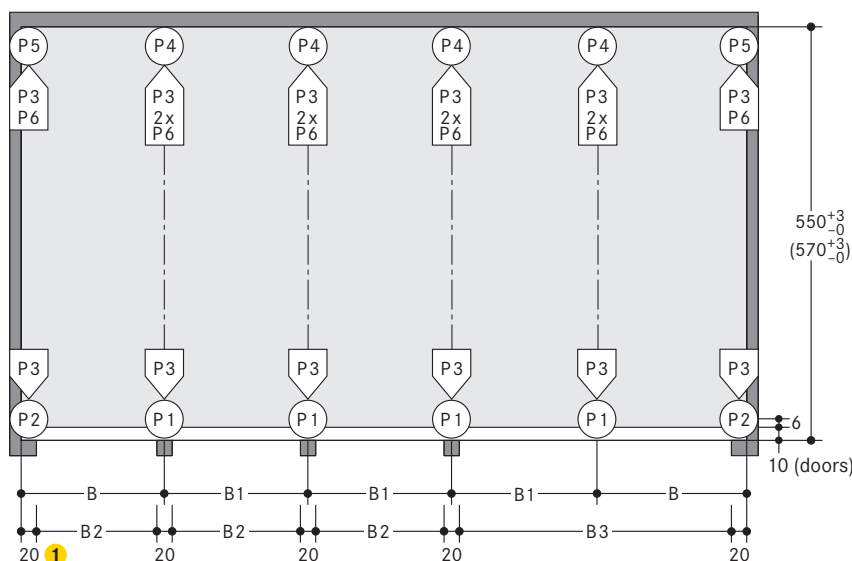

Space requirements				clear platform width
B	B1	B2	B3	
280	270	250	520	250
290	280	260	540	260
300	290	270	560	270
310	300	280	580	280 ②
320	310	290	600	290 ②
330	320	300	620	300 ②

① If the width of the pillars is more than 20 cm, than the width of the drive through will be reduced accordingly to the above mentioned width dimensions (B and B1). In order to avoid this, we recommend to extend the measures between the pillars (B2 and B3) accordingly. Please contact WÖHR.

② Platform load max. 2600 kg

Notes and directions

Scope of application

- suitable for residential buildings, office buildings and business premises, hotels
- only for long-term users that have been instructed on how to use the system
- for frequently changing users (e.g. for office, hotel and business premises or similar):
 - performance of technical system adjustments is necessary
 - please consult with WÖHR

Function

- one empty space per unit on entrance level
- platforms on entrance level are moved sideways
- platforms on the upper and lower levels are lifted or lowered to the empty space on the entrance level

Numbering of the parking places

- empty space on the entrance level on the left
- numbering:

UL	1	3	6	9	12
EL		4	7	10	13
LL	2	5	8	11	14

- the numbering for each unit starts with 1
- different numbering of parking places is possible at extra cost (software changes are necessary)

Hydraulic power pack

- Arrangement of the hydraulic power pack:
- within the unit

Noise protection

Basis is the German DIN 4109 "Noise protection in buildings".

With the following conditions required 30 dB (A) in rooms can be provided:

- noise protection package from our accessory
- insulation figure of the construction of min. $R_w = 57$ dB
- walls which are bordering the parking systems must be done as single wall and deflection resistant with min. $m' = 300$ kg/m²
- solid ceiling above the parking systems with min. $m' = 400$ kg/m²

At differing constructional conditions additional sound absorbing measures are to be provided by the customer.

The best results are reached by separated sole plates from the construction.

Increased sound insulation (separate agreement):

It is based on VDI 4100 „Sound insulation in building construction“ Assessment and proposals for increased sound insulation.

Under the following conditions, 25 dB (A) can be complied with in living spaces and bedrooms:

- sound insulation package according to offer/order
- Sound insulation value of the building structure of min. $R_w = 62$ dB (to be performed by the customer)

Note:

User noises are not subject to the requirements (see VDI 4100, Scope - Notes). User noises are basically noises that can be individually influenced by the user of the parking systems (e.g. driving on the platform, closing of vehicle doors, engine and brake noises).

Drainage

Water leaks into the pit:

- in the winter, up to 40 litres of snow water can possibly come with the wheel housings in just one parking process

Drainage channels:

- along the middle section of the pit
- connecting to a floor drain or drainage pit (50 x 50 x 20 cm)
- with manual emptying out of the drainage pit
- alternatively installation of a pump or drainage channel into the sewerage system, to be performed by the customer

Sideways slope drainage:

- only into a gutter
- not possible in the remaining pit section

Lengthways slope drainage:

- provided according to specified construction dimensions

Environmental safety:

- coating of the pit flooring is recommended
- installation of an oil and/or petrol separator unit between the drainage connection and the main sewerage system is recommended

Declaration of conformity



The parking systems correspond to:

- EC Machinery Directive 2006/42/EC
- DIN EN 14010

Switch cabinet

- Arrangement of the switch cabinet:
- within the unit

Temperature

- system operating range: +5° bis +40°C (with unloaded platforms and low temperatures, a reduced lowering speed is to be expected)
- humidity: 50 % at +40° C
- if use in deviating temperature ranges is planned, constructive adjustments may be necessary (please consult with WÖHR)

Lighting

- sufficient lighting of the driving aisle and of the parking places must be performed by the customer

Fire safety

- all fire safety requirements and all mandatory equipment (fire extinguisher and fire alarm systems, etc.) must be performed by the customer
- WÖHR will provide documents on attachment points and clearances for sprinklers on request

Railings

If walkways are arranged directly to the side or behind the systems, railings have to be provided by the customer acc. to local requirements, height min. 200 cm – this is applicable during the construction phase too.

Maintenance

- WÖHR and all the WÖHR partners abroad provide an installation and customer service network
- regular, annual maintenance is provided subject to the stipulation of a maintenance agreement
- local requirements for electrical doors regarding the technology, maintenance and revision are not subject of our delivery. These matters have to be observed and carried out by the customer, according to the local regulations.

Prevention of corrosion damage

- all operations listed in the WÖHR Cleaning and Maintenance Instructions are to be performed regularly (independently of maintenance operations)
- zinc-plated parts, components and platforms are to be kept clean of dirt, road-salt and any other debris (due to corrosion hazards)
- always keep the garage well ventilated and deaerated



Surface protection

- please consider the information on surface protection!



Tender specification

- please consider the specifications!



Parking Place-Profile

- please consider the product information Parking Place-Profile!



Electromobility

- please consider the product information E-charging!
- depending on the position of the charging point on the electric vehicle, collision points with protruding plugs and charging cables can occur



Sliding doors and Operating concepts

- please consider the product information Sliding doors and Operating concepts!



Construction formalities

- the documentation necessary for construction permit applications is provided by WÖHR on demand

Construction alterations and/or modifications

- the right to construction or model modifications and/or variations is hereby reserved
- the right to any subsequent part modification and/or variation and amendments in procedures and standards due to technical and engineering progresses or due to environmental regulation changes is also hereby reserved